



August Smart Lock Pro Integration Release Notes

Content

Preface...1

Introduction...1

Installing and programming the August Smart Lock Pro...2

Pairing and removing the August Smart Lock Pro...2

Using the door lock in the ClareHome app...21

Contact information...21

Last modified: 08/11/20

Preface

For information on Z-Wave and ClareHome, see [Installing Z-Wave with ClareHome Tech Bulletin \(DOC ID 1162\)](#).

Notes

- When installing Z-Wave devices, ensure that there is nothing inhibiting their signal. Z-Wave relies on radio signals. Metal or thick walls may limit their signal strength.
- We recommend having 2 or more repeating Z-Wave devices that support beaming.

Introduction

The August Smart Lock Pro is a Z-Wave door lock. The August door lock works with your existing door lock, allowing it to be controlled via Z-Wave. The lock integrates with ClareHome via the Z-Wave network. Installers only need to pair (add) the unit into the ClareHome. The locks provide real time lock status indications.

By integrating the lock into the ClareHome control system, your customers can control the door lock from their Android or iOS devices.

Note: The August Smart Lock Pro does not support PIN codes.

Installing and programming the August Smart Lock Pro

Only qualified installation technicians should install August Smart Door Lock. Follow the installation and programming instructions that came with your August equipment. We recommend that you pair the lock with the ClareHome Z-Wave controller before installing it in the door.

Notes

- You must be within 6 feet of the controller for the lock to pair.
- The door lock is configurable using the ClareHome app, the Clare Controls Install Assist app, and Fusion.
- The August Home app is required to install and pair the August Smart Lock Pro.

Pairing and removing the August Smart Lock Pro

We recommend pairing the August lock using FusionPro.

Notes

- The August app images included in this document are subject to change at any time.
- The August Smart Lock does not support PIN codes.
- Refer to the August Home app for connection instructions for the August Smart Lock Pro.

To pair the door lock with FusionPro:

1. Click **Accounts** in the side menu.

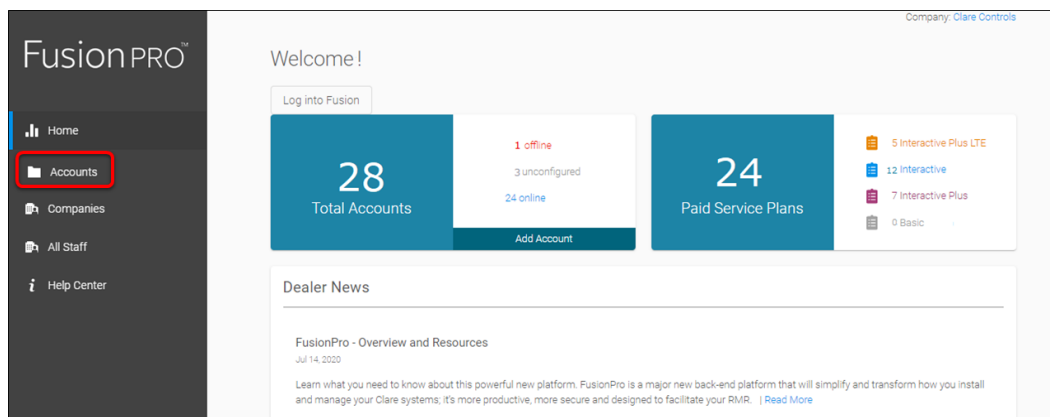

2. Locate the desired account in the list, and then click **View**.

The Account sub-menu is now available.

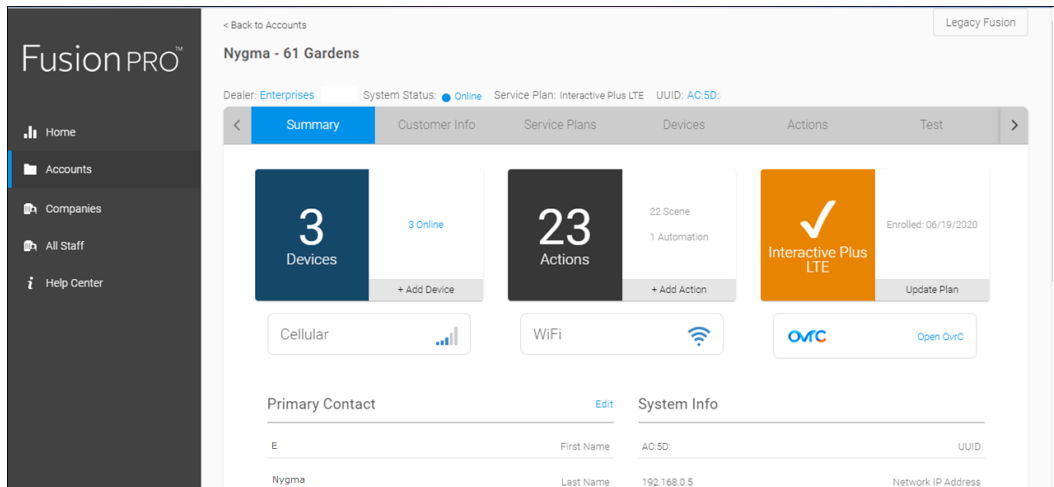

3. Click the **Devices** tab, and then click **Add Devices**.

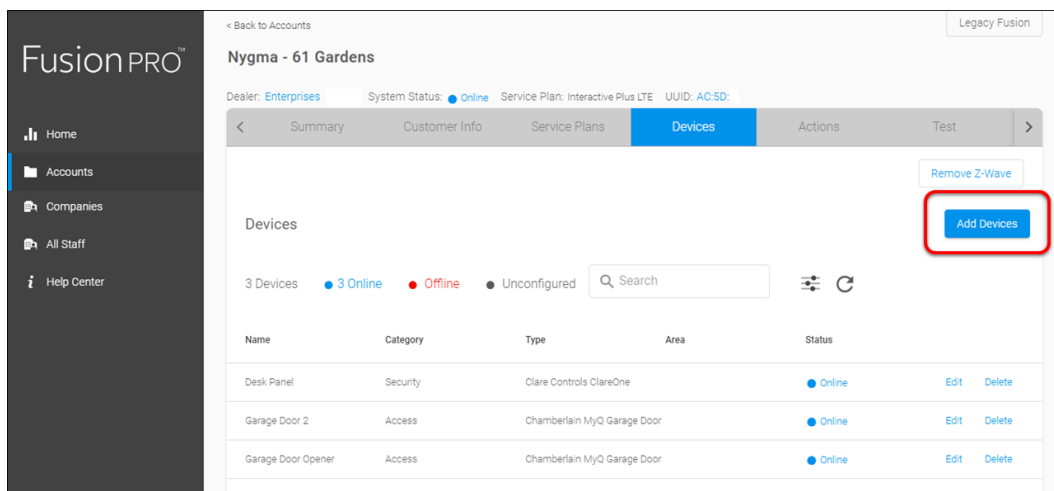

4. Select the device category (**Access**) and then the device type (**Z-Wave Device – Access**).

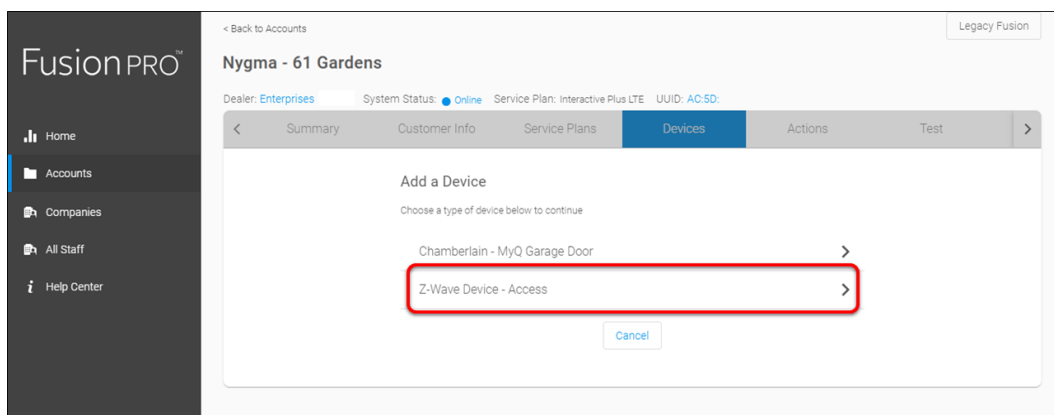

5. Click **Add a Z-Wave Device**, and then click **Start Discovery Mode**.

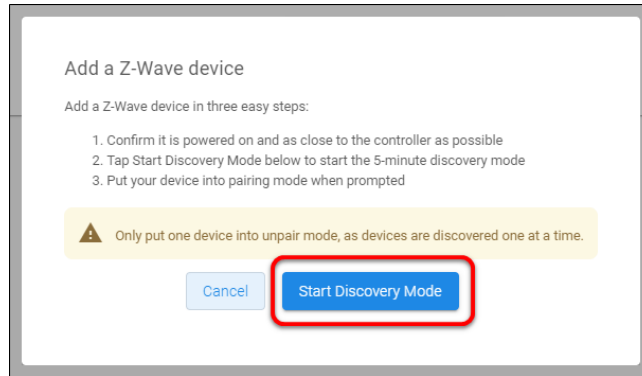

A popup displays waiting for a notification from the device, pair the Z-Wave device according to the manufacturer's instructions for each device.

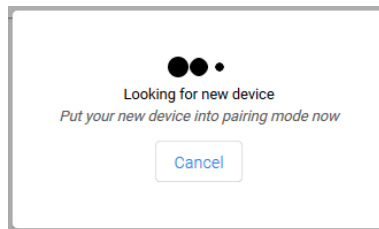

6. Access the August Home app on a mobile device, and then tap the August door lock.

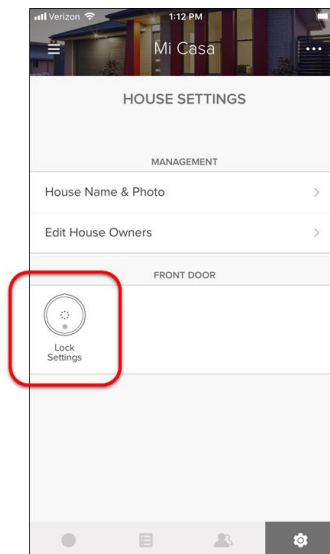

7. Scroll to view Z-Wave Settings, and then tap **Z-Wave Settings**.

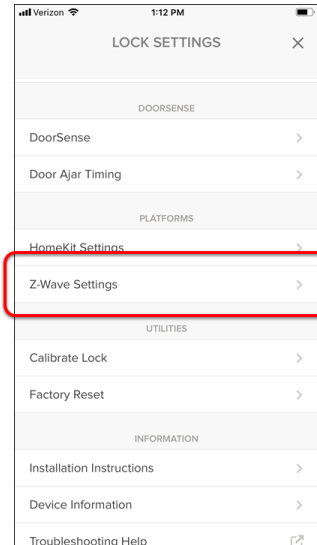

8. Tap **ADD TO A Z-WAVE NETWORK**.

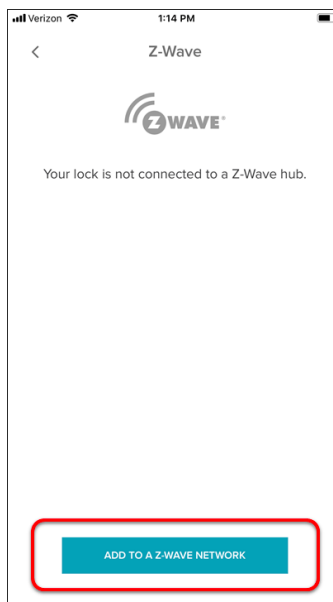

9. Tap **MY HUB IS IN INCLUSION MODE**.

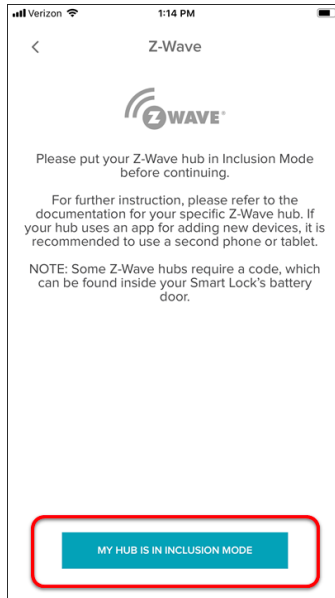

The device door lock enters pairing mode.

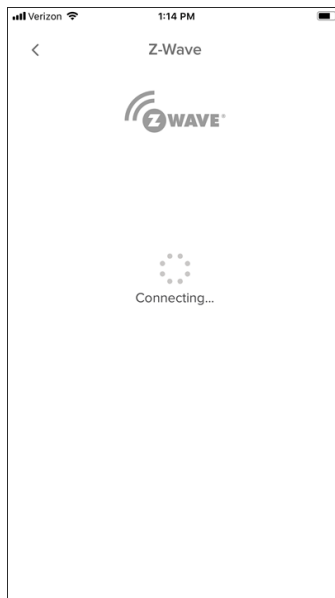

10. Return to FusionPro, and then change the name and assign the desired area.

The screenshot shows the 'Edit Device' page in FusionPro. The left sidebar contains the FusionPro logo and navigation links: Home, Accounts, Companies, All Staff, and Help Center. The main content area is titled 'Nygma - 61 Gardens' and includes a breadcrumb trail: < Back to Accounts. Below this, there are tabs for Summary, Customer Info, Service Plans, Devices (selected), Actions, and Test. The 'Edit Device' section is divided into 'Basic Device Info' and 'Advanced Configuration'. In 'Basic Device Info', the 'Device Name' is 'Door Lock' and the 'Device Area' is set to 'August - Door Lock'. The 'Device Area' dropdown is currently set to 'Select an Area --'. The 'Status' is 'Online'. A 'Save' button is at the bottom left, and a 'Back to Devices' button is at the bottom right.

11. Once all desired changes are made, tap **Save**.

To remove the door lock with FusionPro:

1. Click **Accounts** in the side menu.

The screenshot shows the 'Accounts' page in FusionPro. The left sidebar contains the FusionPro logo and navigation links: Home, Accounts (highlighted with a red box), Companies, All Staff, and Help Center. The main content area is titled 'Welcome!' and includes a 'Log into Fusion' button. Below this, there are three large cards: '28 Total Accounts' with a sub-total of '1 offline', '3 unconfigured', and '24 online'; '24 Paid Service Plans'; and a list of service plans: '5 Interactive Plus LTE', '12 Interactive', '7 Interactive Plus', and '0 Basic'. A 'Dealer News' section is at the bottom, featuring a link to 'FusionPro - Overview and Resources' dated Jul 14, 2020.

2. Locate the desired account in the list, and then click **View**.

The Account sub-menu is now available.

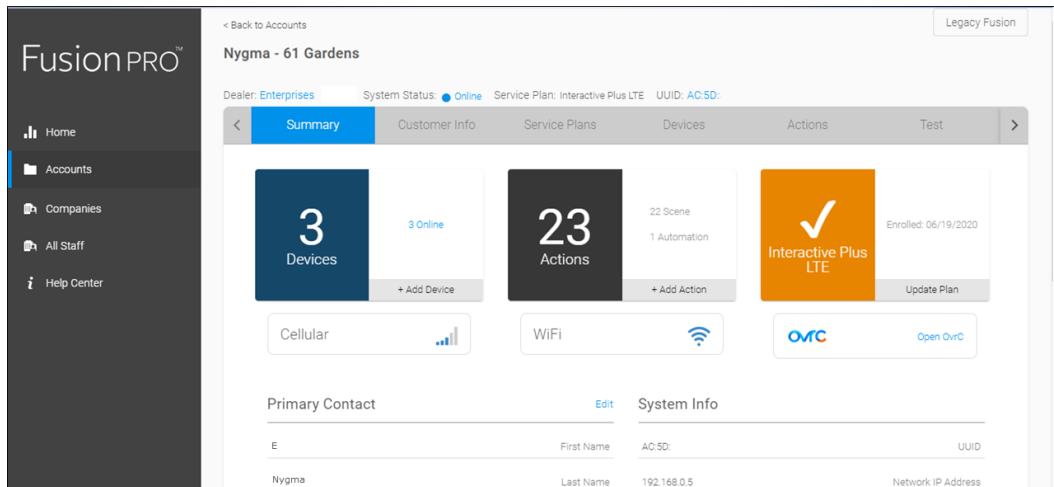

3. Click the **Devices** tab, and then click **Remove Z-Wave**.

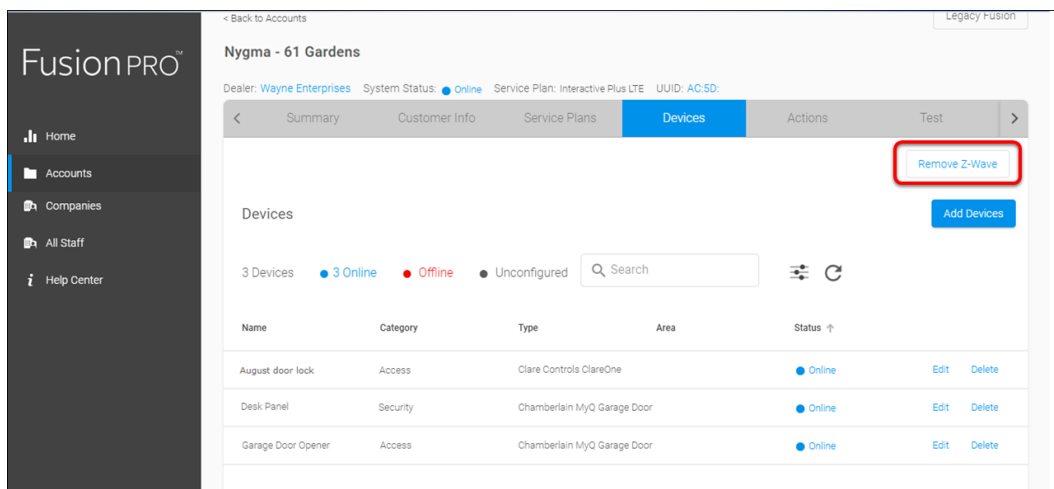

4. Click **Start Removal Mode**.

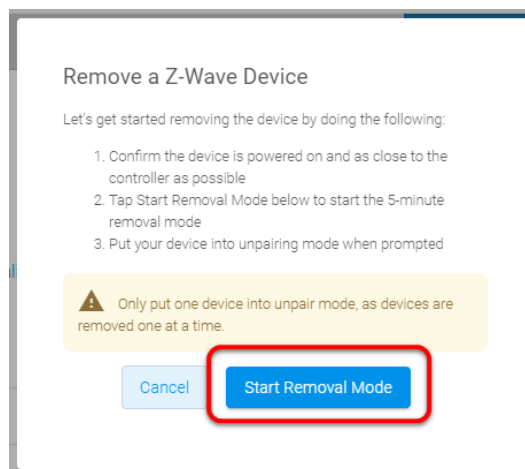

5. Access the August Home app on a mobile device, and then tap the August door lock.

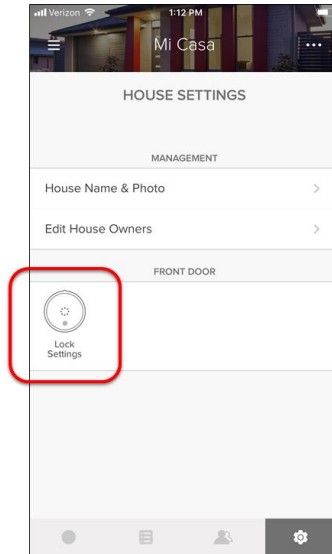

6. Scroll to view Z-Wave Settings, and then tap **Z-Wave Settings**.

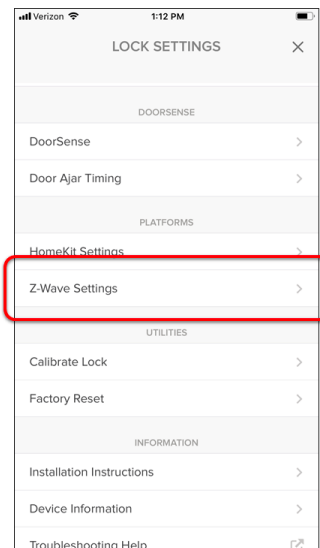

7. Tap **REMOVE Z-WAVE DEVICE**.

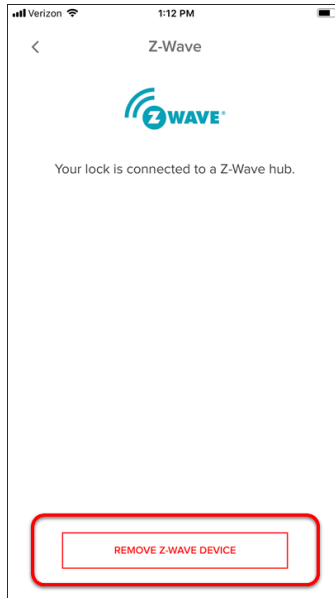

8. Tap **MY HUB IS IN LEARN MODE**.

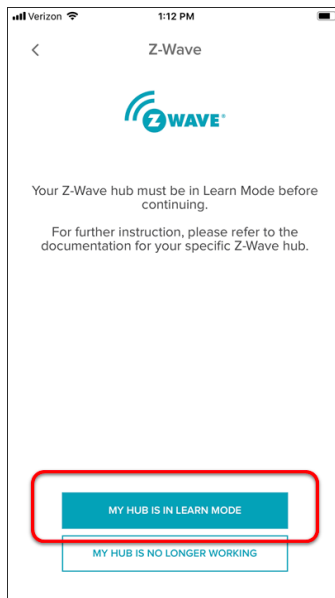

The device door lock enters removal mode.

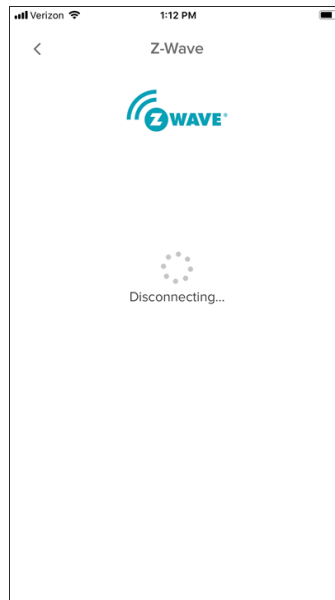

The door lock is removed from the devices list.

To pair the door lock using ClareHome:

1. Access the August Home app on a mobile device, and then tap the August door lock.

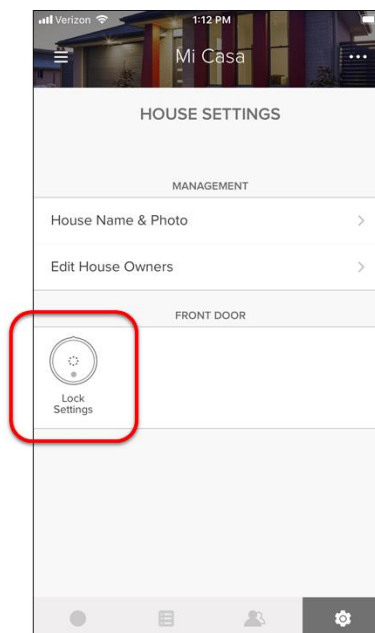

2. Scroll to view Z-Wave Settings, and then tap **Z-Wave Settings**.

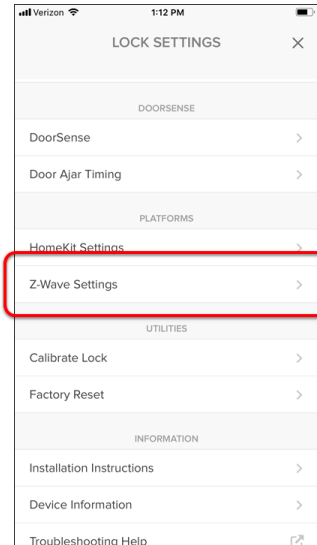

3. Tap **ADD TO A Z-WAVE NETWORK**.

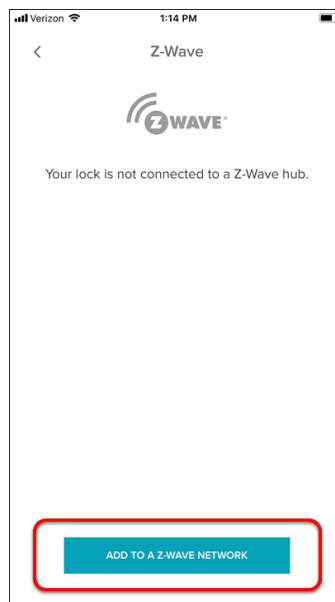

4. Tap **MY HUB IS IN INCLUSION MODE**.

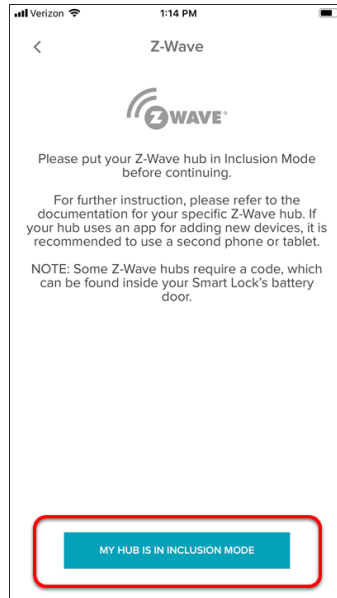

The device door lock enters pairing mode.

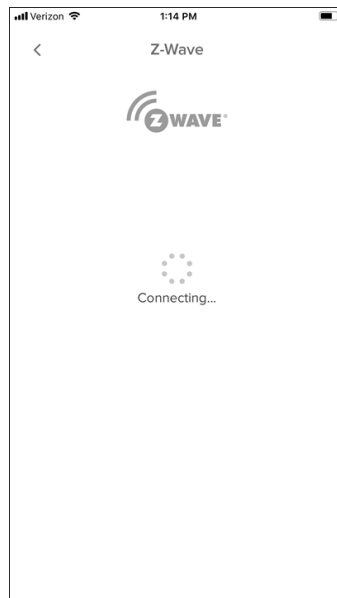

5. Access the ClareHome app, and then tap the **Devices** icon .

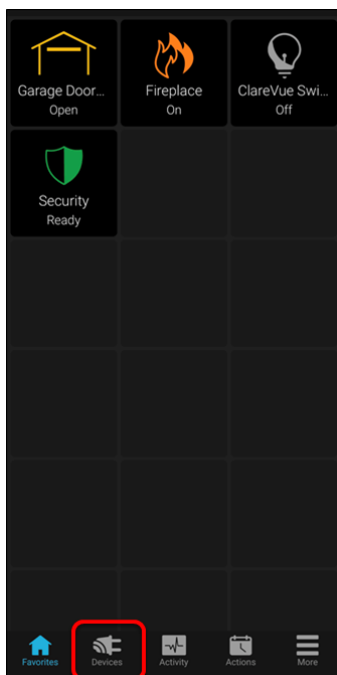

6. Tap **+ Add Device**.

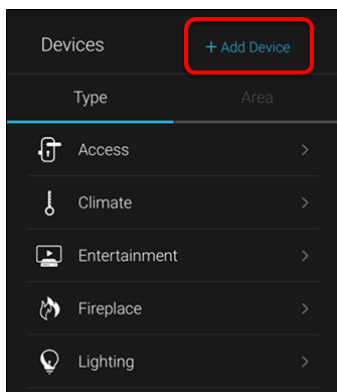

7. Tap **Add Devices**.

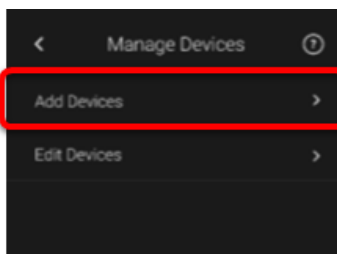

8. Select the device category, **Access**.

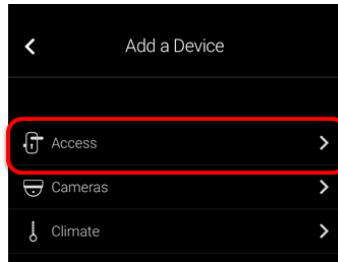

9. Select the device type, **Z-Wave Device - Access**.

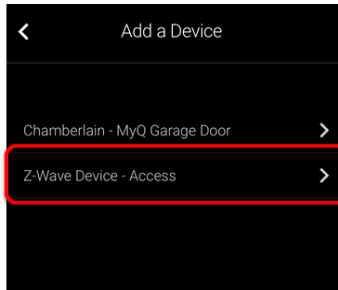

10. Read through the displayed information, and then tap **Add Z-Wave Device**.

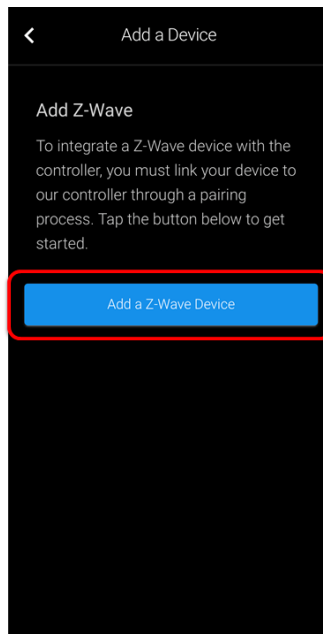

11. Read the Z-Wave information, and then tap **Start Discovery Mode**.

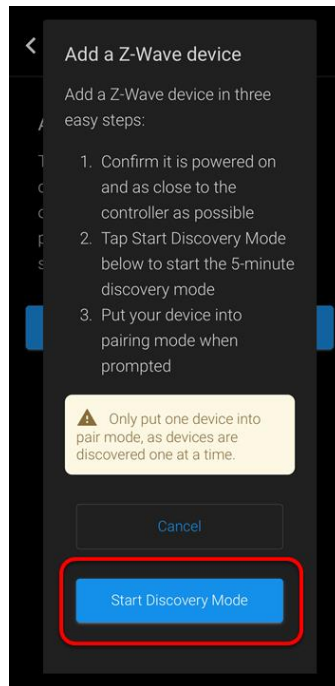

12. When prompted, pair the lock as per the device manufacturer's instructions.

13. Once paired in, the Edit Device page displays.

Customize the device name and location as desired, tapping **Save** when done.

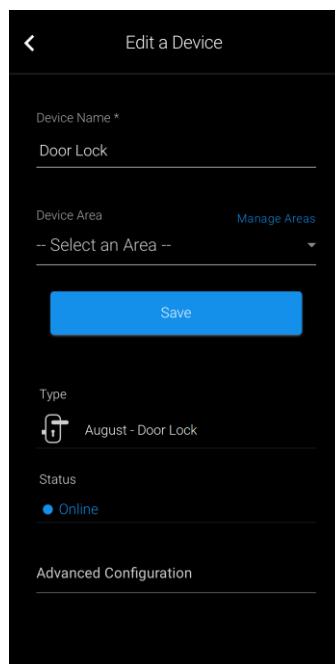

Note: For notification, scenes, schedule, and automation configuration, see [ClareHome App Guide \(DOC ID 1750\)](#).

To remove the door lock using ClareHome:

1. Access the August Home app on a mobile device, and then tap the August door lock.

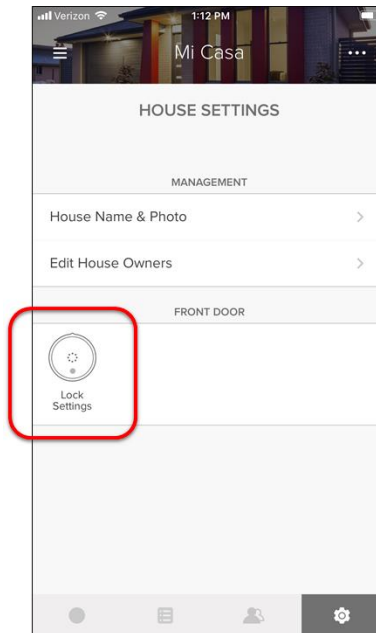

2. Scroll to view Z-Wave Settings, and then tap **Z-Wave Settings**.

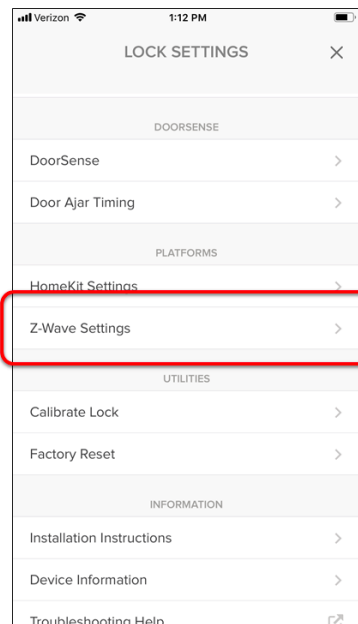

3. Tap **REMOVE Z-WAVE DEVICE**.

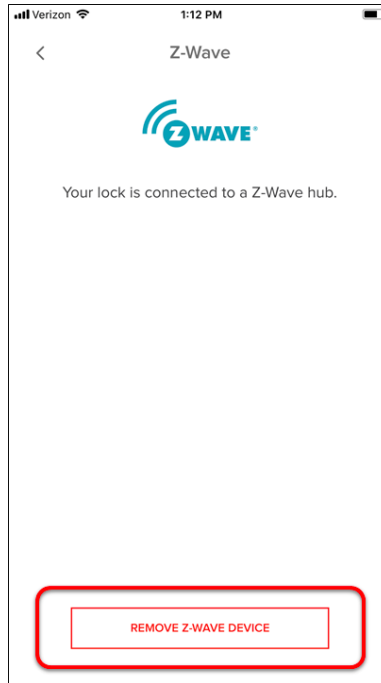

4. Tap **MY HUB IS IN LEARN MODE**.

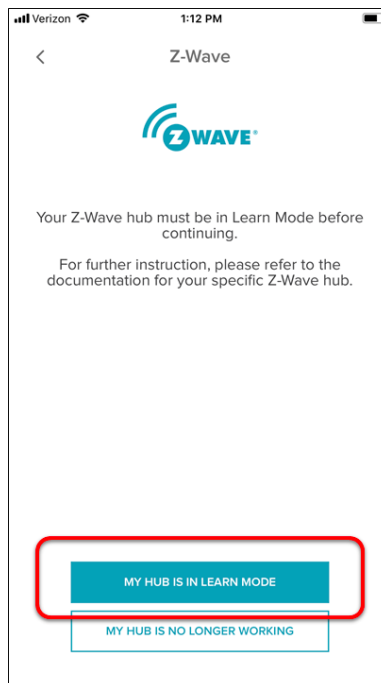

The device door lock enters removal mode.

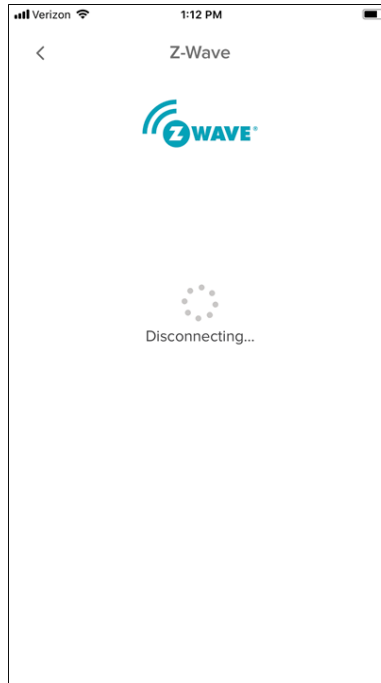

5. Access the ClareHome app, and then tap the **Devices** icon .

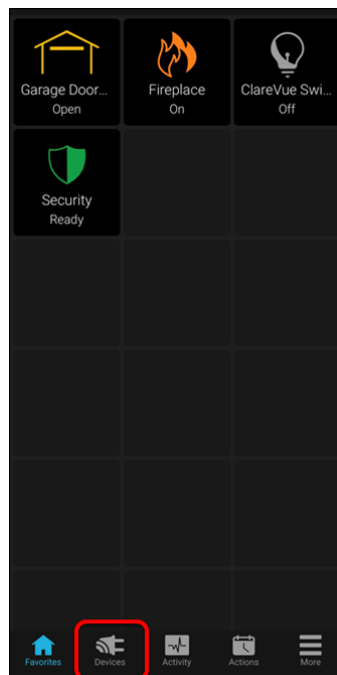

6. Tap **Access**.

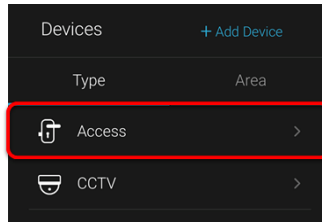

7. Tap the 3 dots next to the door lock, and then tap **Remove**.

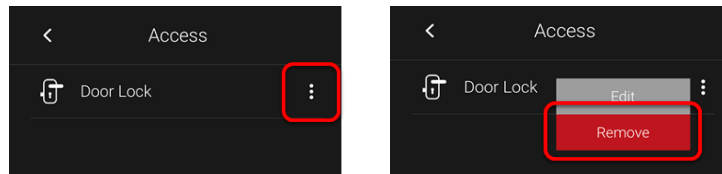

8. Read through the displayed information, and then tap **Start Removal Mode**.

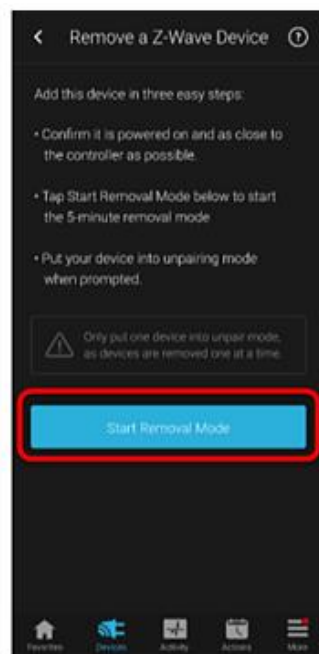

9. Use the manufacturer's instructions for lock removal.

Using the door lock in the ClareHome app

Once added, the user can add the device to their favorites page.

Figure 1: Locked and unlocked August Smart Lock display

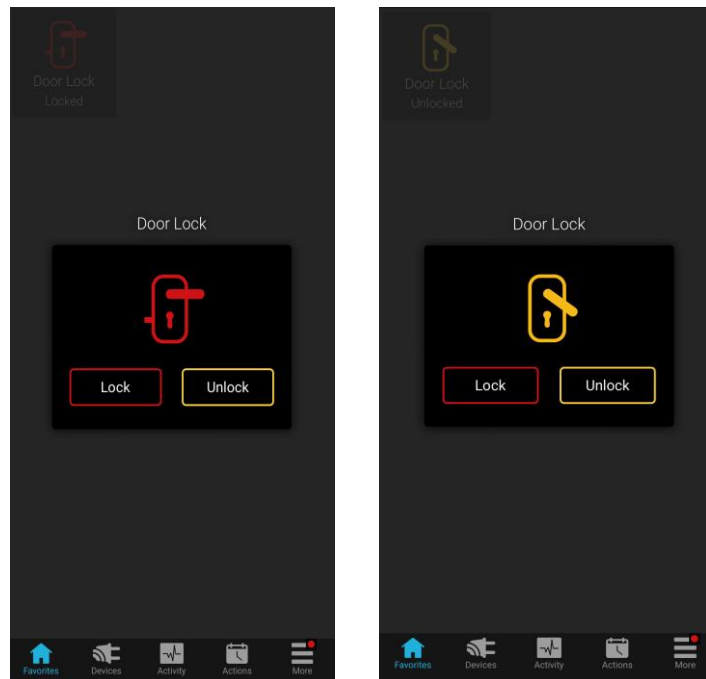

Contact information

Clare Controls, LLC.
7519 Pennsylvania Ave, Suite 104
Sarasota, FL 34243

General: 941.328.3991

Fax: 941.870.9646

www.clarecontrols.com

Integrator/Dealer Support: 941.404.1072

claresupport@clarecontrols.com

Homeowner Support (ClareCare): 941.315.2273 (CARE)

help@clarecontrols.com